

# Parts List

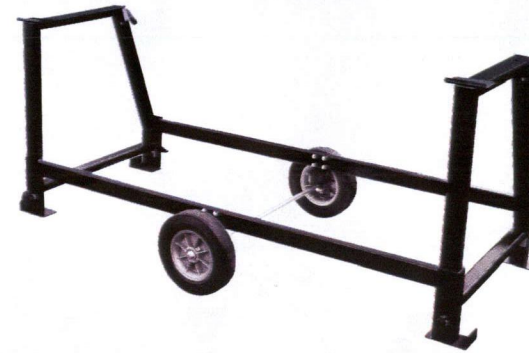
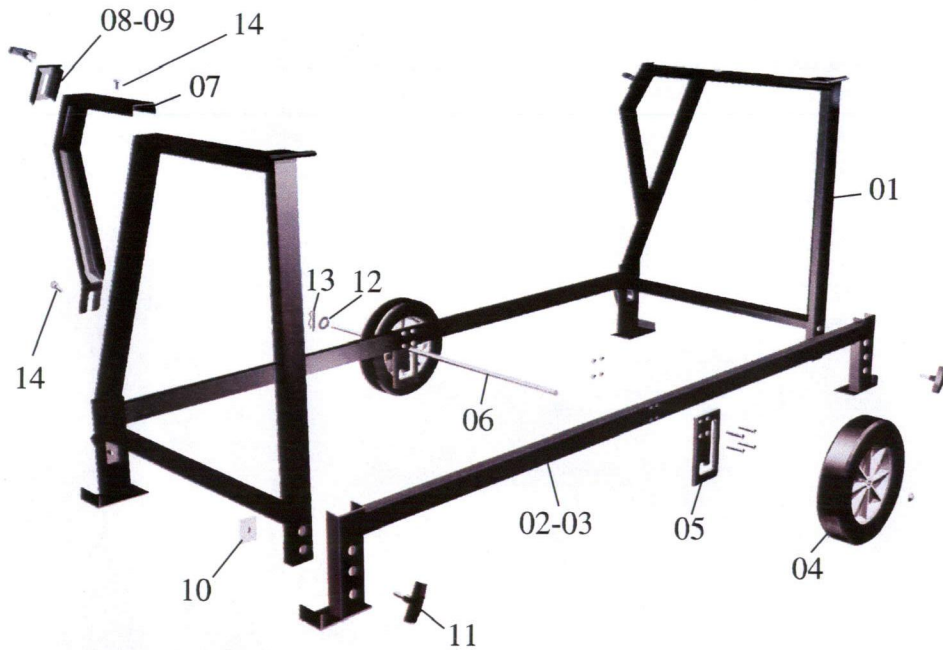

**USA1EZ**  
All 6' 6" thru 12' 6"  
TAB I, TAB II, Mark I,  
TrimMaster® & TAT50/TAT60

**USA1EZXL**  
Recommended For All  
14' 6" TAB I, TAB II, Mark I  
& TrimMaster®

Ref	Description	Part No's	Qty. Required
01	End Assembly	5400	2
02	Cross Brace 60"	5415	2
03	Cross Brace 78" (XL)	5416	2
04	Wheel	5419	2
05	Axle Bkt.	5417	2
06	Axle	5418	1
07	Extension, EZ2	5413	2
08	Latch Plate EZ1	5403	2
09	Latch Plate EZ2	5414	2
10	Nut Plate	5420	4
11	T Knob	2036	6
12	5/8" Washer	2514	1
13	Hairpin, Cotter	2706	1
14	3/8 Hex Screw	2035	4



**USA2EZ**  
All Metal Master® 20™  
Models 6' 6" thru 12' 6"

**USA2EZXL**  
Recommended For  
Metal Master® 20™ Model 14' 6"

24145 Industrial Park Dr., Farmington Hills, MI 48335

Toll Free No. 1-800-Van Mark  
Phone No. 1-248-478-1200

Toll Free Fax 1-888-Van Mark  
Area Fax No. 1-248-478-1226

Web site: [www.van-mark.com](http://www.van-mark.com) E-Mail [sales@van-mark.com](mailto:sales@van-mark.com)

UniStandEZ-Go.indd 16 md 06-29-11

©2002-2011 Van Mark Products Corp. F635np



User's Guide

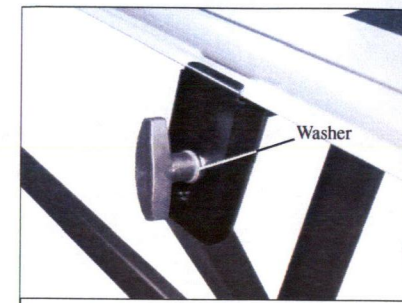

Insert 3/8" Washer over threads on T-Knobs. Extend through slots in Latch Plate and thread into opening in rear of End Assembly (leave loose with Latch Plate below mounting surface for now).

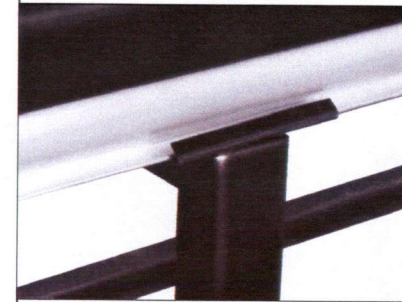

Place the lip edge of the Front Base Rail fully into the opening in each Retainer as shown. Lower Brake fully onto mounting surface.

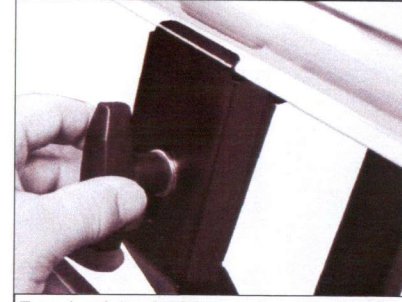

Extend each Latch Plate up and over the lip edge and firmly tighten each T Knob. Brake should now be secured to Stand. Check T Knobs often and tighten as needed.

Trim-A-Table™  
Trim-A-Brake II™



Insert front lip edge of Tool as described in Step 2 above. With Tool centered in Stand, place Latch Plate in horizontal position and over rear lip edge of Tool. Tighten each T Knob firmly.

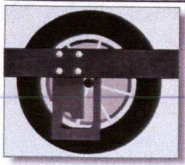

Idle Position. When not engaged, wheels stay retracted and out of the way allowing 4-point support for unmatched stability.

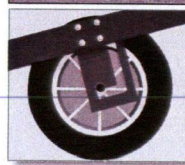

To engage wheels, simply lift carrying handle at end of brake and let gravity pull axle to bottom of slot.

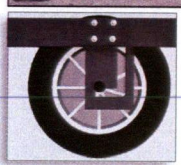
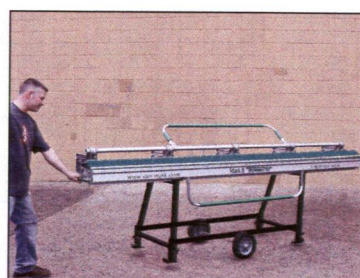

When axle comes to rest against end of the slot, lower brake to capture axle in fixed position. You can now easily maneuver tool anywhere needed.

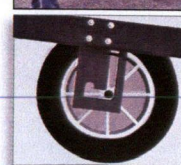
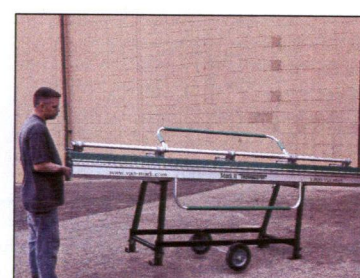

To disengage, lift opposite end and let axle travel back. As you lower the brake, the axle will float within the slot until you engage it again.